



CHINMORE INDUSTRY CO.,LTD

Specification

1. Product Type: GPS & GSM Adhesive Mount

Antenna for cars

2. Chinmore's No: R30 series

3. Frequency for GPS: 1575.42 MHz

Frequency for GSM: 900/1800 MHz

4. Cable RG-174 0.5m with SMA (M) ST connector

✧RoHS Compliant

✧ISO 9001 & ISO 14001

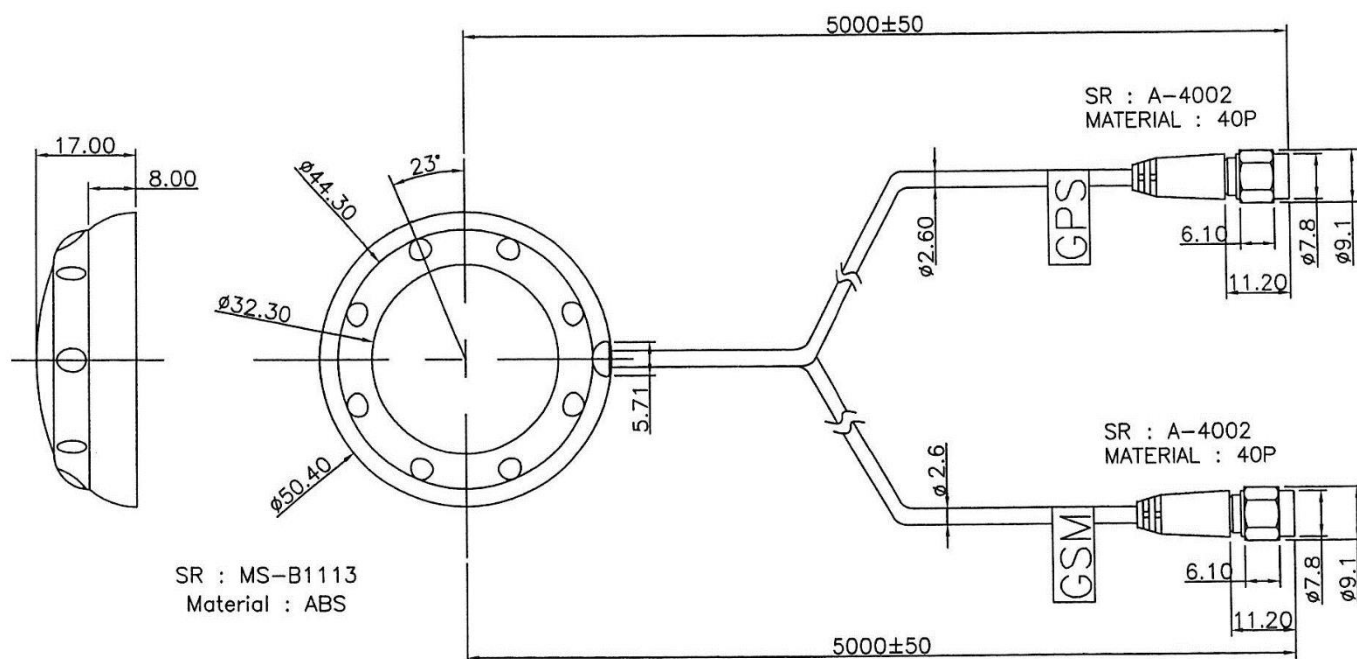

ELECTRICAL

Frequency (MHz)	Return Loss (dB)	VSWR	Efficiency (%)	Gain (dB)
1575.42	-26.81	1.15	-----	28.69
900	-15.17	1.43	8.22	-5.91
1800	-19.01	1.26	63.97	3.2

1. TEST REPORT(GPS)

511 Log Mag 10.00dB/ Ref 0.000dB

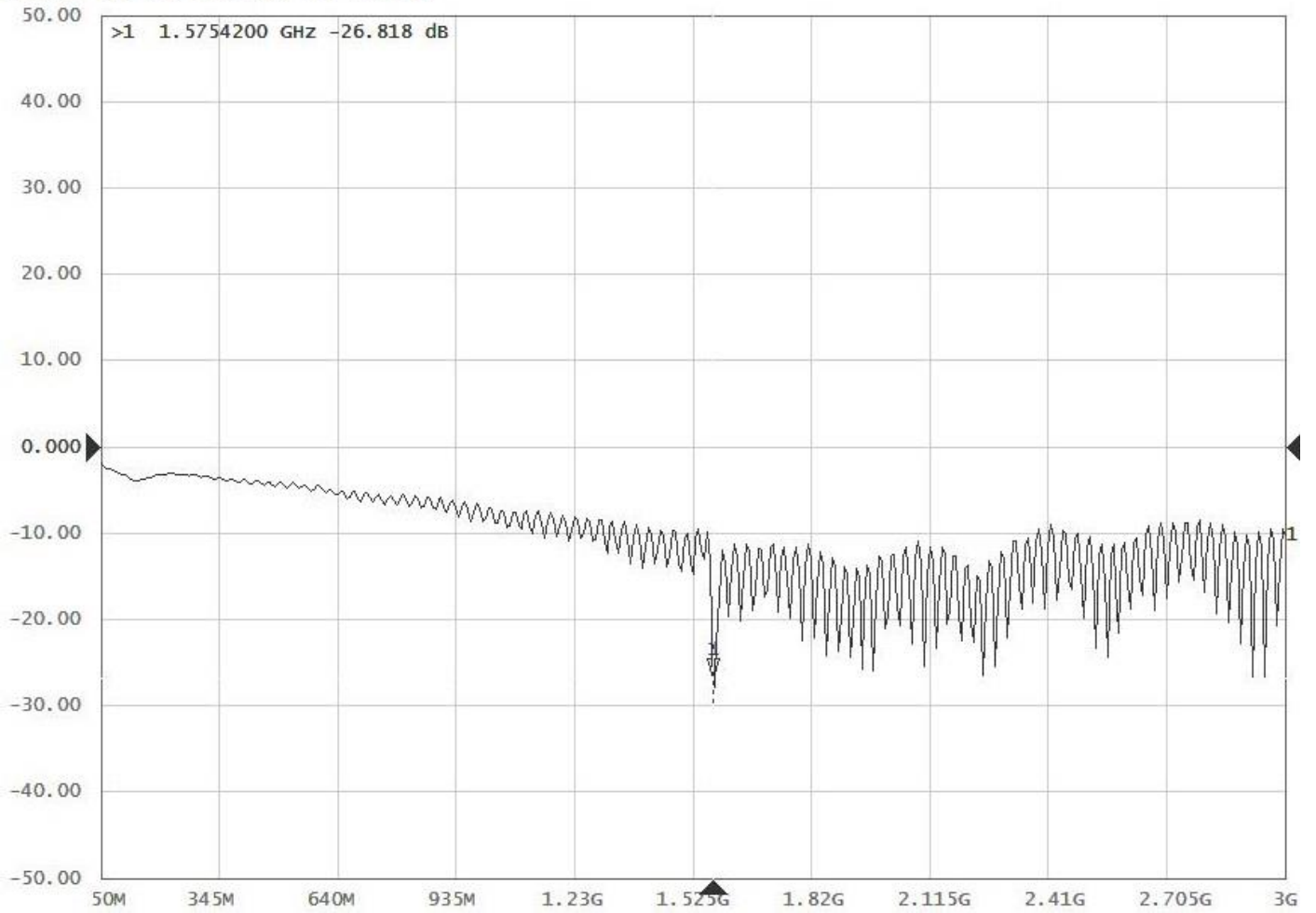

Tr1 S11 SWR 1.000/ Ref 1.000

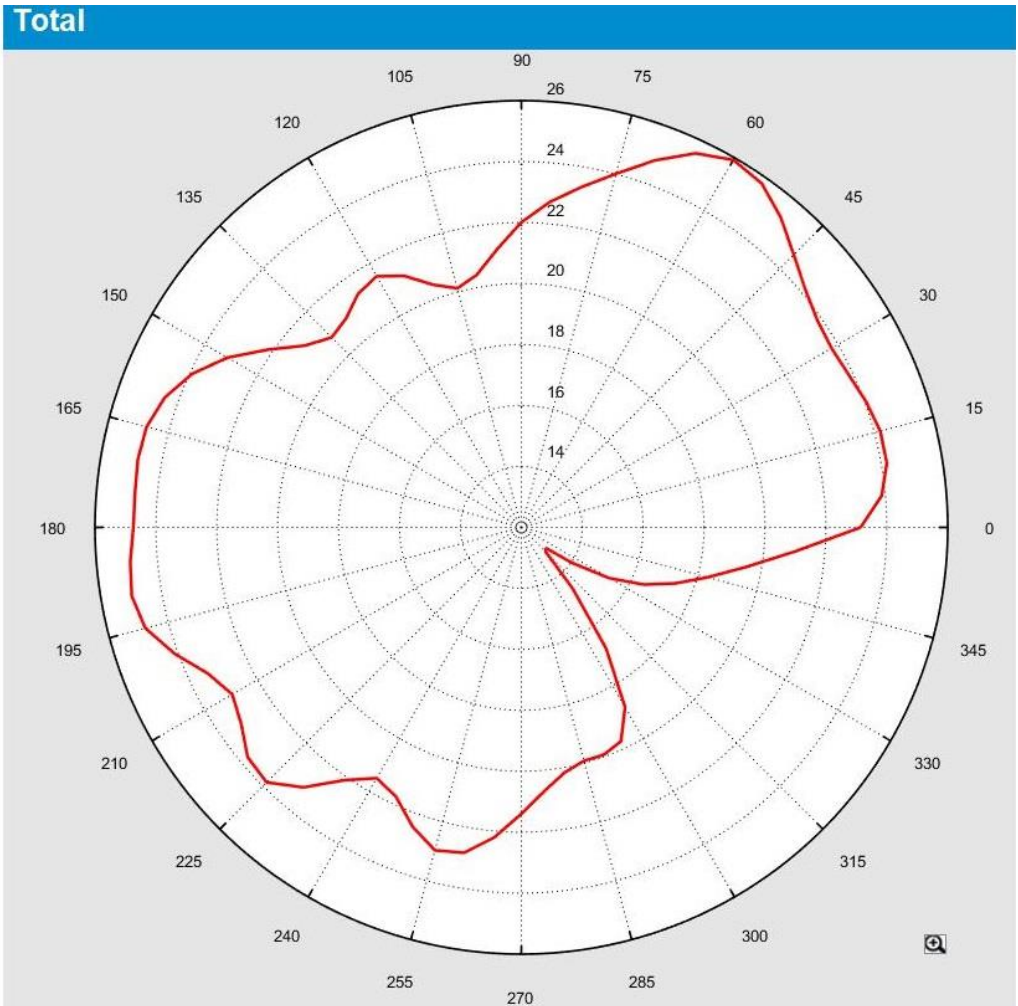
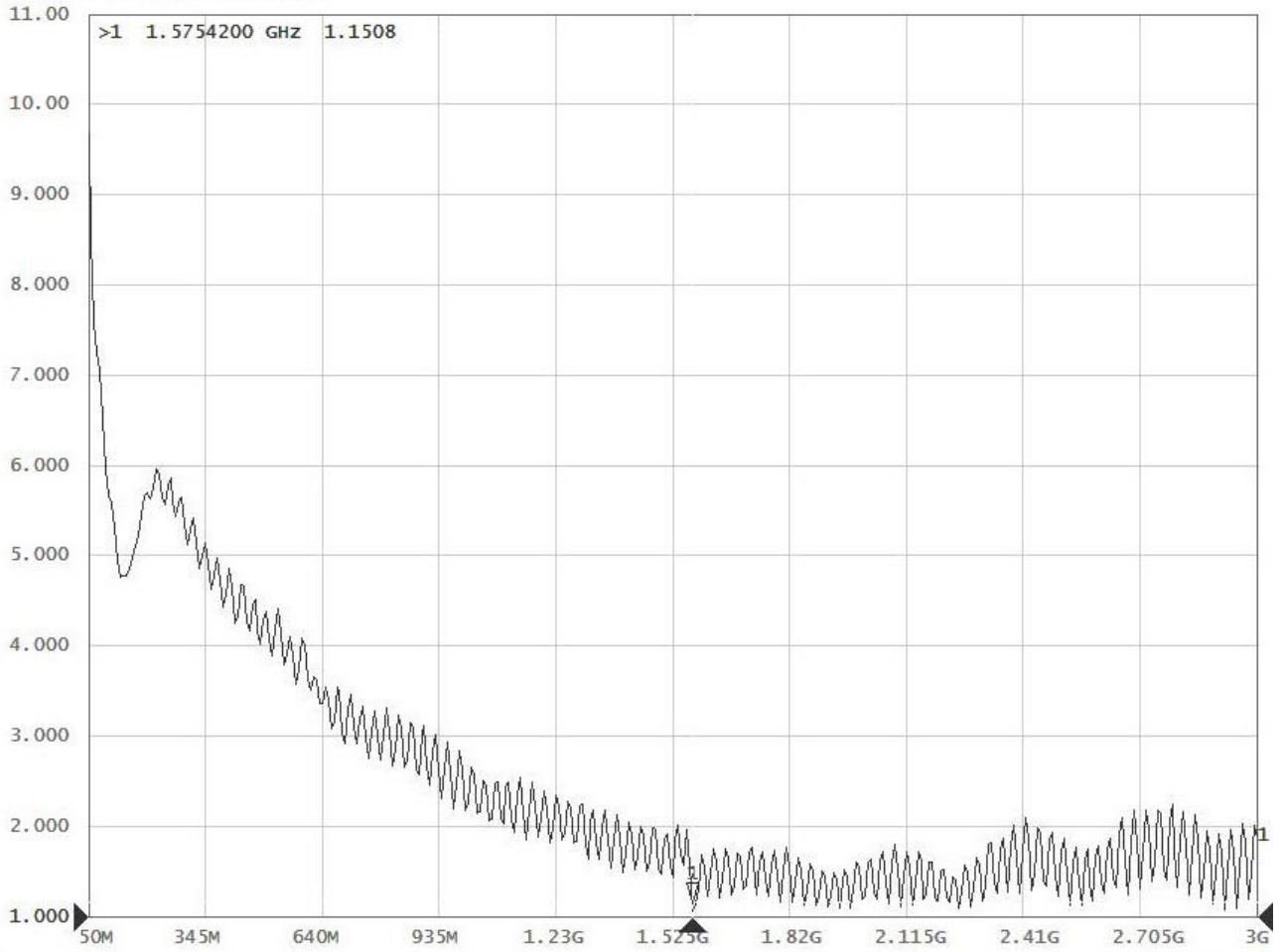

Total_3D_Side View 1_1.57542GHz

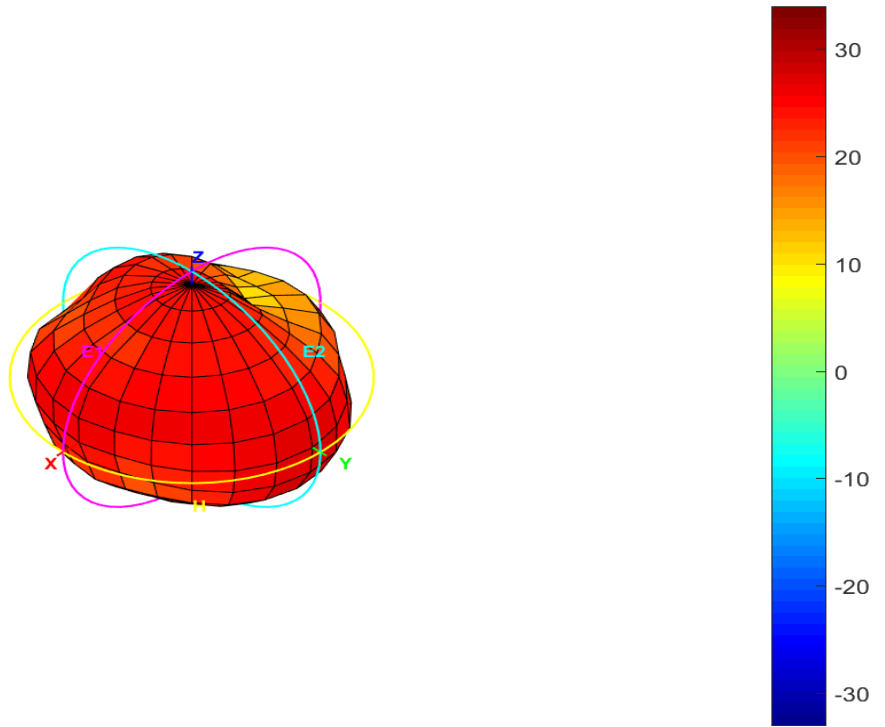

2. TEST REPORT(GSM)

RFI S11 Log Mag 10.00dB/ Ref 0.000dB

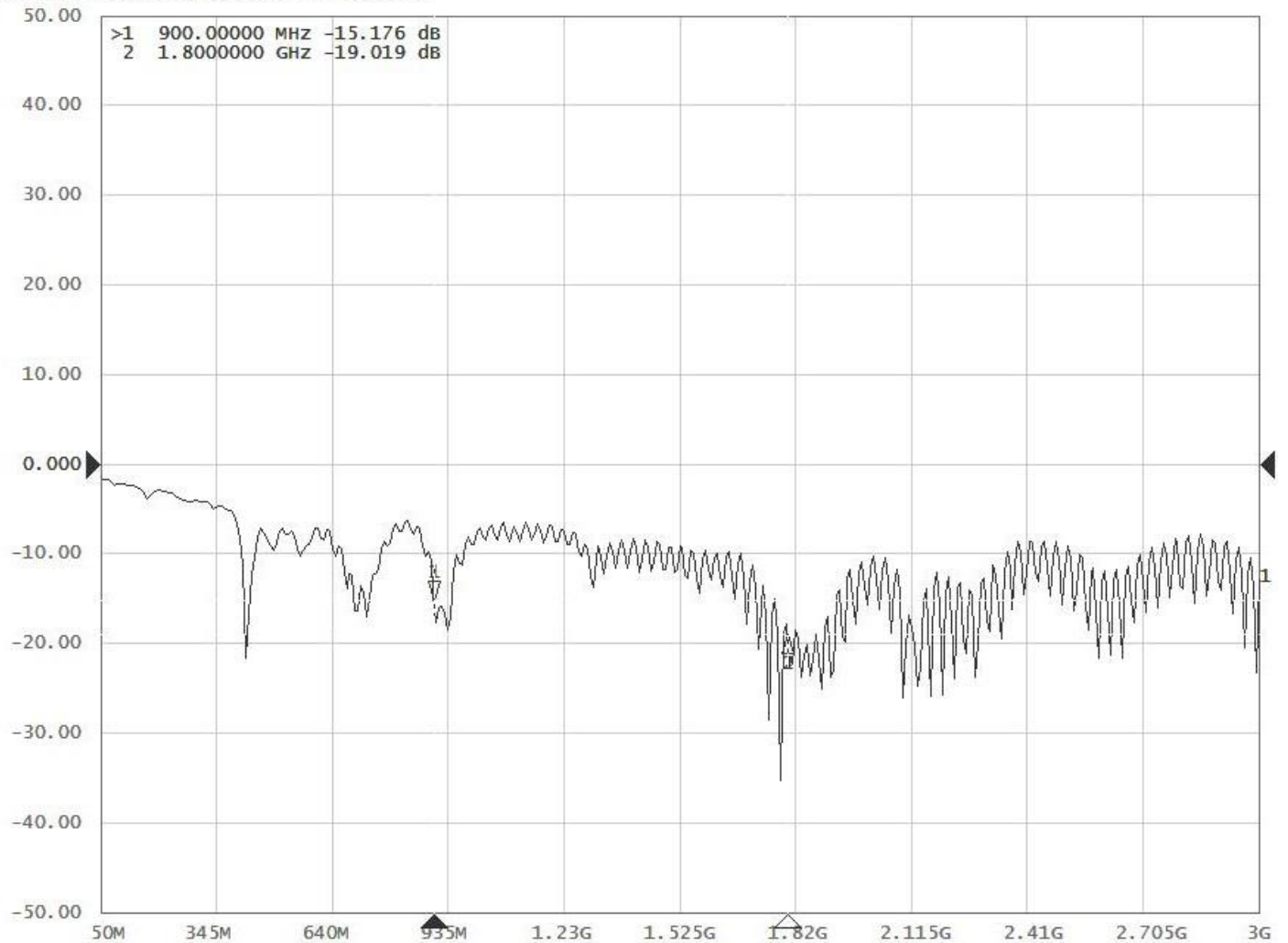

Tr1 S11 SWR 1.000/ Ref 1.000

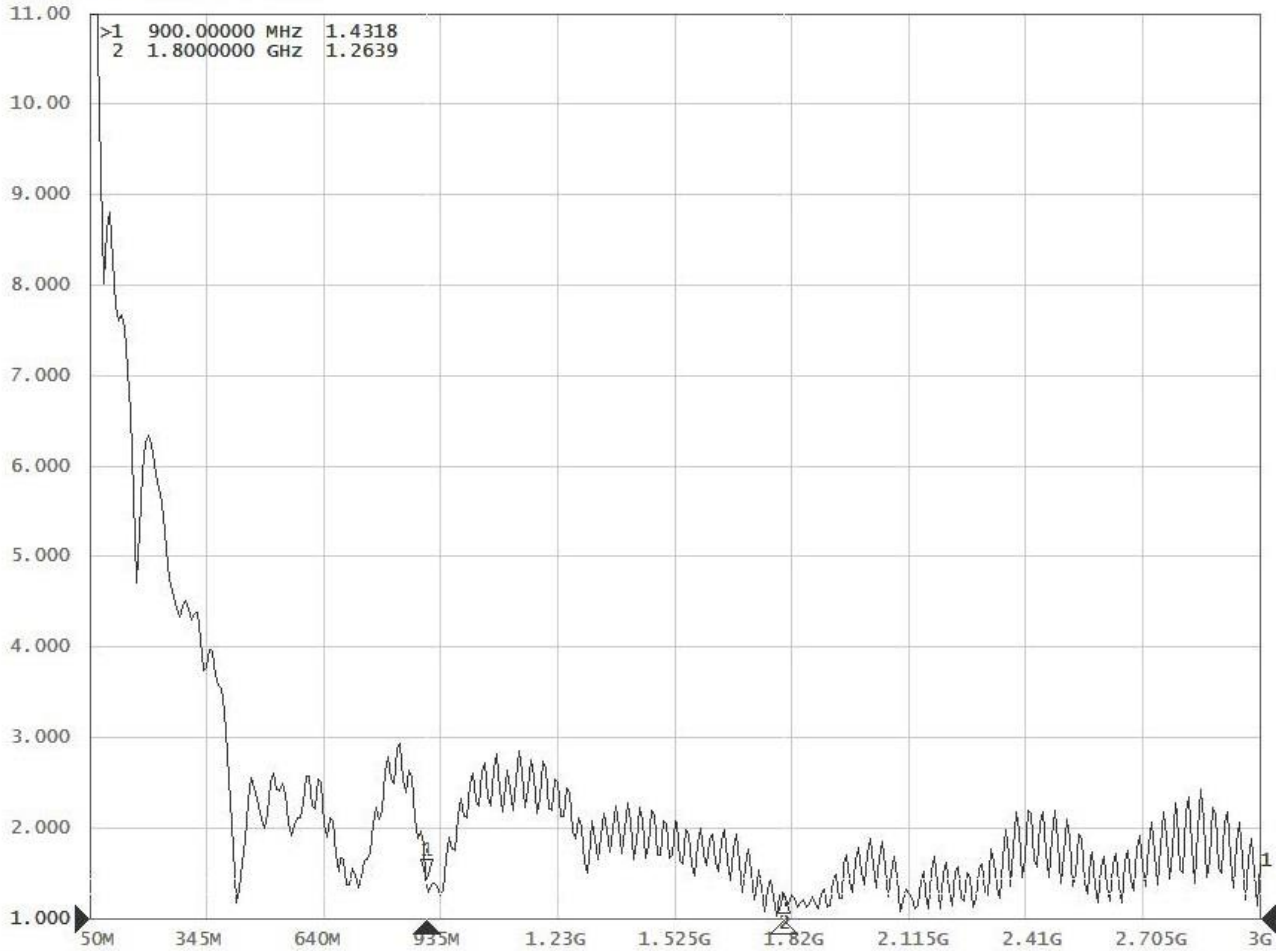

Total

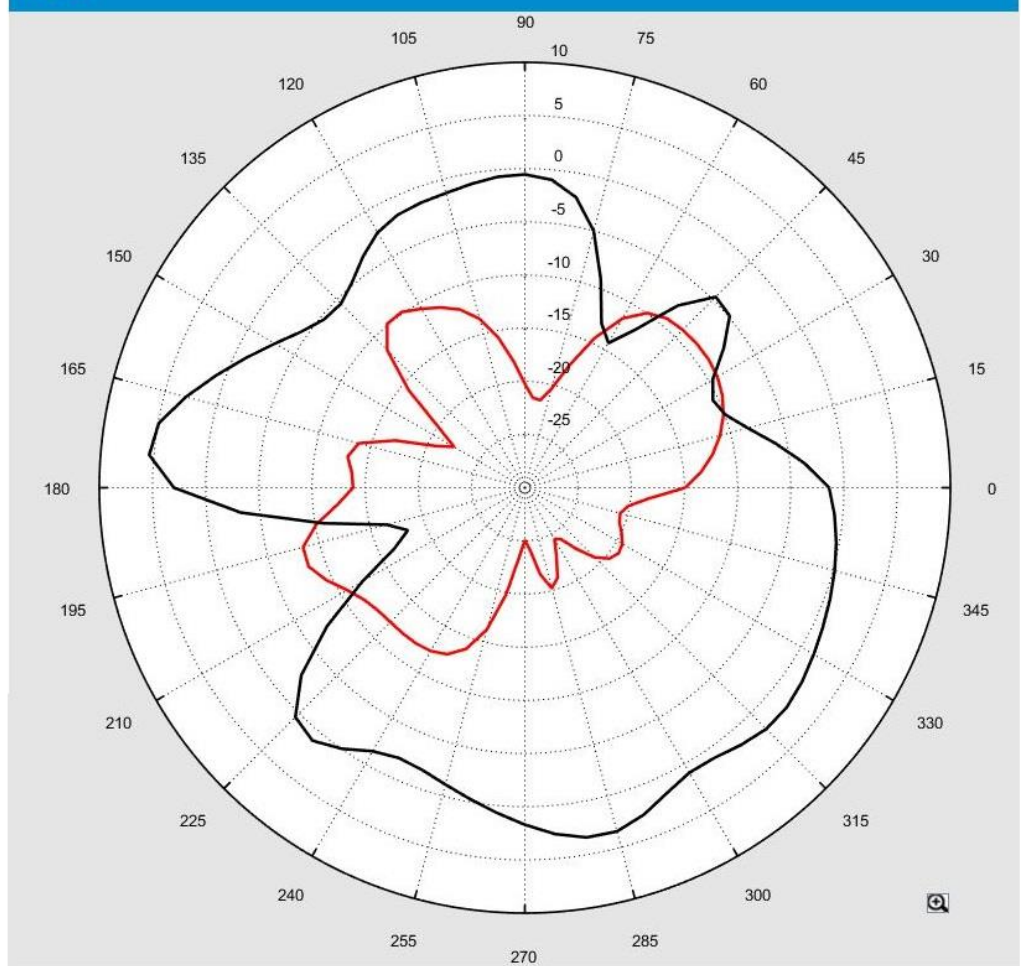

Freq. / Chan.	Color
900MHz	Red
1.8GHz	Black

Total_Efficiency (%)

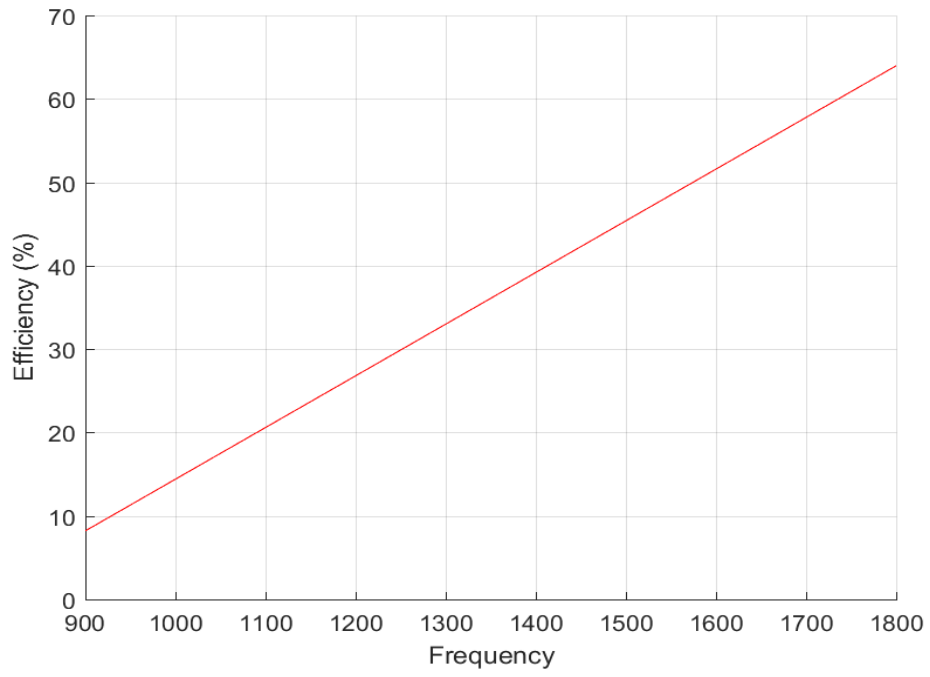

Total_Gain (dBi)

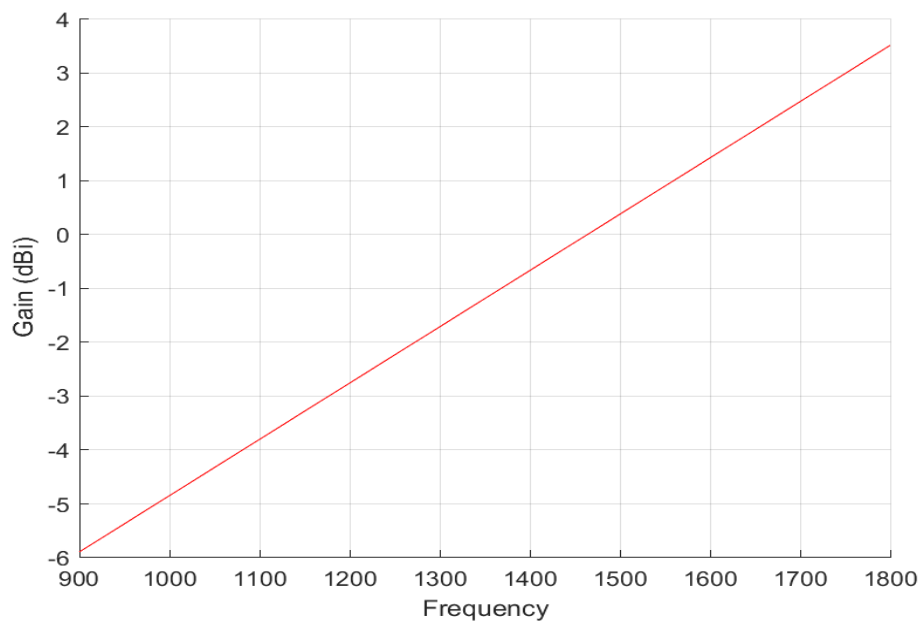

Total_3D_Side View 1_900MHz

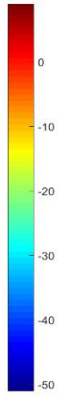
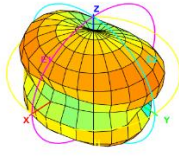

Total_3D_Side View 1_1.8GHz

